

**Air turbin at 58.000 rpm for micromachining.
BT 30 spindle - automatic tool changer**



TURBODRILL

air drive

equipment for ROBODRILL



TURBODRILL Up to 60.000 RPM

Air input from shank max.6 Bar

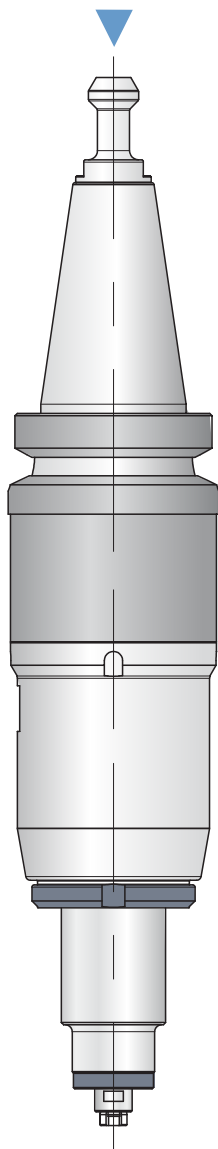

Air line kit

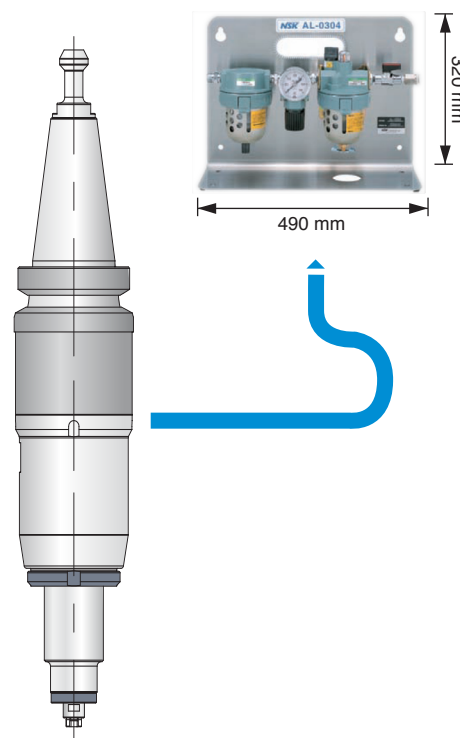

Air line Kit

Technical Data

NR-601

RPM max.	min ⁻¹	58.000
Type motor		AM-600
Collet	mm	CHM ø3
Power	W	76
Rotation		AM-600 RA Right, AM-600 LA Left
Air pressure	bar	max. 6 (max. 90 Psi)
Air consumption	NI/min	160
Type Spindle		NR-601
Weight	Kg	2

Accessories

Collet	mm	CHM: ø0,3 ,ø3 every 0,1 and ø2,35, ø3,175
Air line kit		AL-0304
Retaining block		Special stop block w/air stop valve



TURBODRILL Up to 58.000 RPM

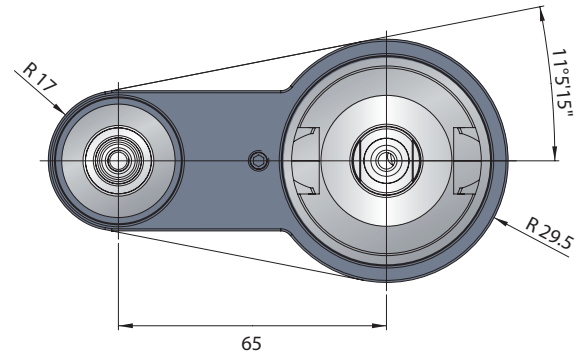
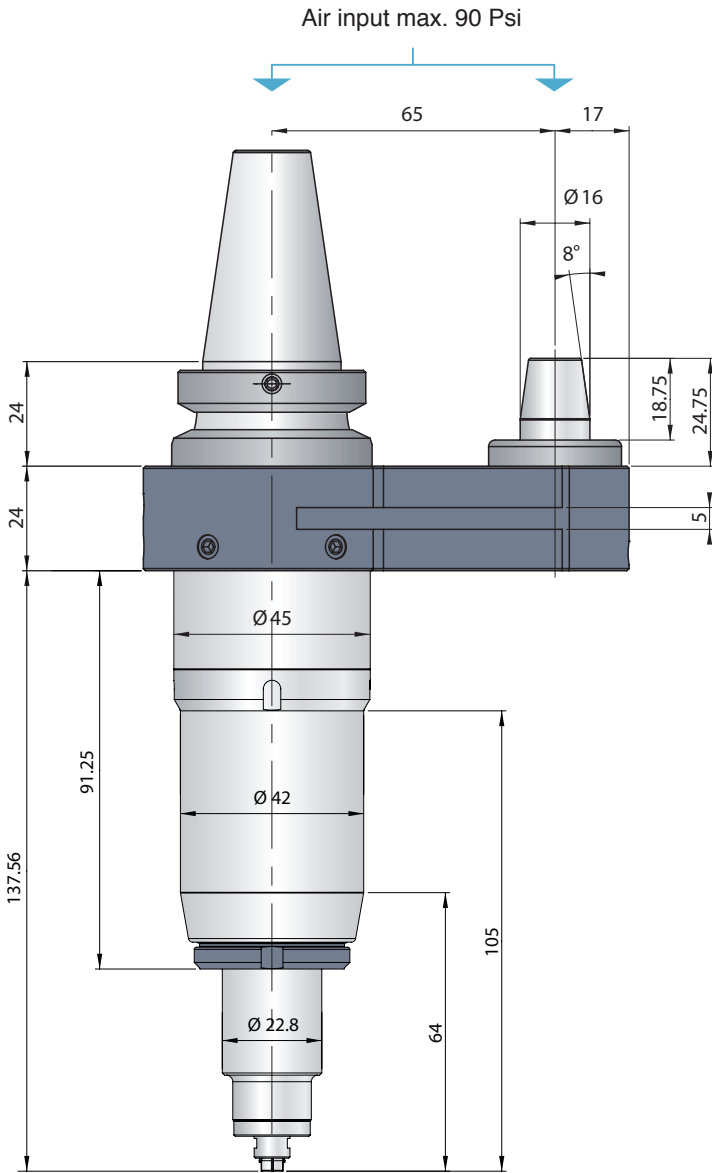

Air line kit

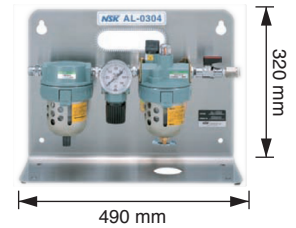

Retaining block / Air line Kit

Technical Data		NR-601
RPM max.	min ⁻¹	58.000
Type motor		AM-600
Collet	mm	CHM Ø3
Power	W	76
Rotation		AM-600 RA Right, AM-600 LA Left
Air pressure	bar	max. 6 (max. 90 Psi)
Air consumption	NI/min	160
Type Spindle		NR-601
Weight	Kg	2

Accessories

Collet	mm	CHM: ø0,3, ø3 every 0,1 and ø2,35, ø3,175
Air line kit		AL-0304
Retaing block		Special stop block w/air stop valve

TURBODRILL Up to 30.000 RPM



Via Gorizia, 37
21047 Saronno (VA)
Italy
Tel. +39 02 96 703 586
Fax +39 02 96 703 620
info@albertiumberto.it

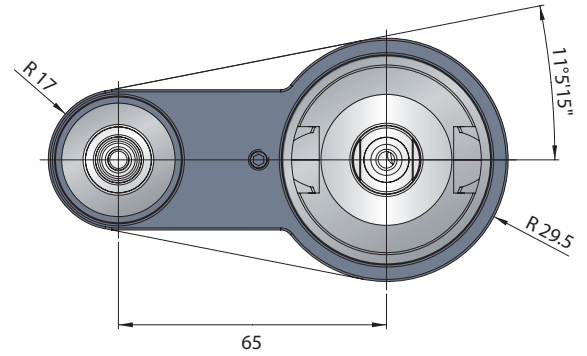
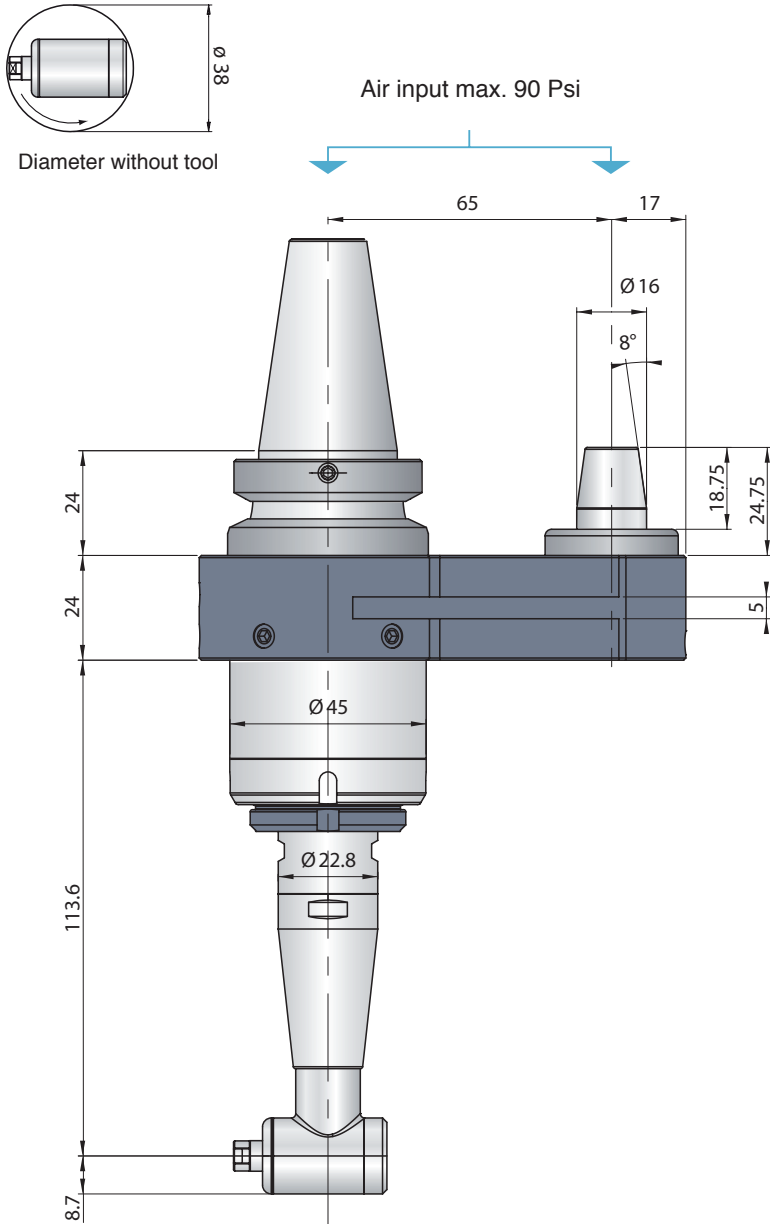

Air line kit

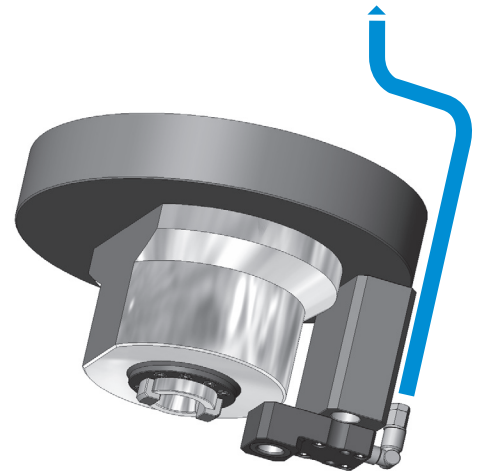
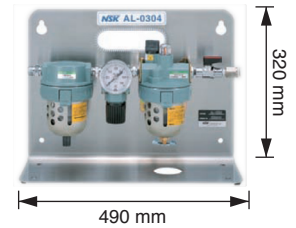

Retaining block / Air line Kit

Technical Data		RA-200
Input RPM max.	min ⁻¹	30.000
Type motor		AM-310
Collet	mm	CHS $\varnothing 3$
Power	W	108
Rotation		AM-310 RA Right, AM-310 LA Left
Air pressure	bar	max. 6 (max. 90 Psi)
Air consumption	NI/min	226
Type Spindle		RA-200
Output RPM	min ⁻¹	20.000
Rt. reduction		1/1,5
Weight	Kg	2

STANDARD EQUIPMENT INCLUDES: NAKANISKI KIT / Angle head / Collet / Wrenches / Oil tube / Instruction book

Accessories

Collet	mm	CHS: $\varnothing 0,8$, $\varnothing 3$ every 0,1 and $\varnothing 2,35$, $\varnothing 3,175$
Air line kit		AL-0304
Retaing block		Special stop block w/air stop valve



In case of air through the spindle please use special pull stud!!!



**Solutions up to 58.000 rpm for micromachining.
BT 30 spindle - automatic tool changer**



**TURBODRILL
MINILINE**

DMG MORI SEIKI

MILLTAP 700



TURBODRILL RA-200

Driven through air motor / azionamento con motore ad aria / mit Luftmotor angetrieben

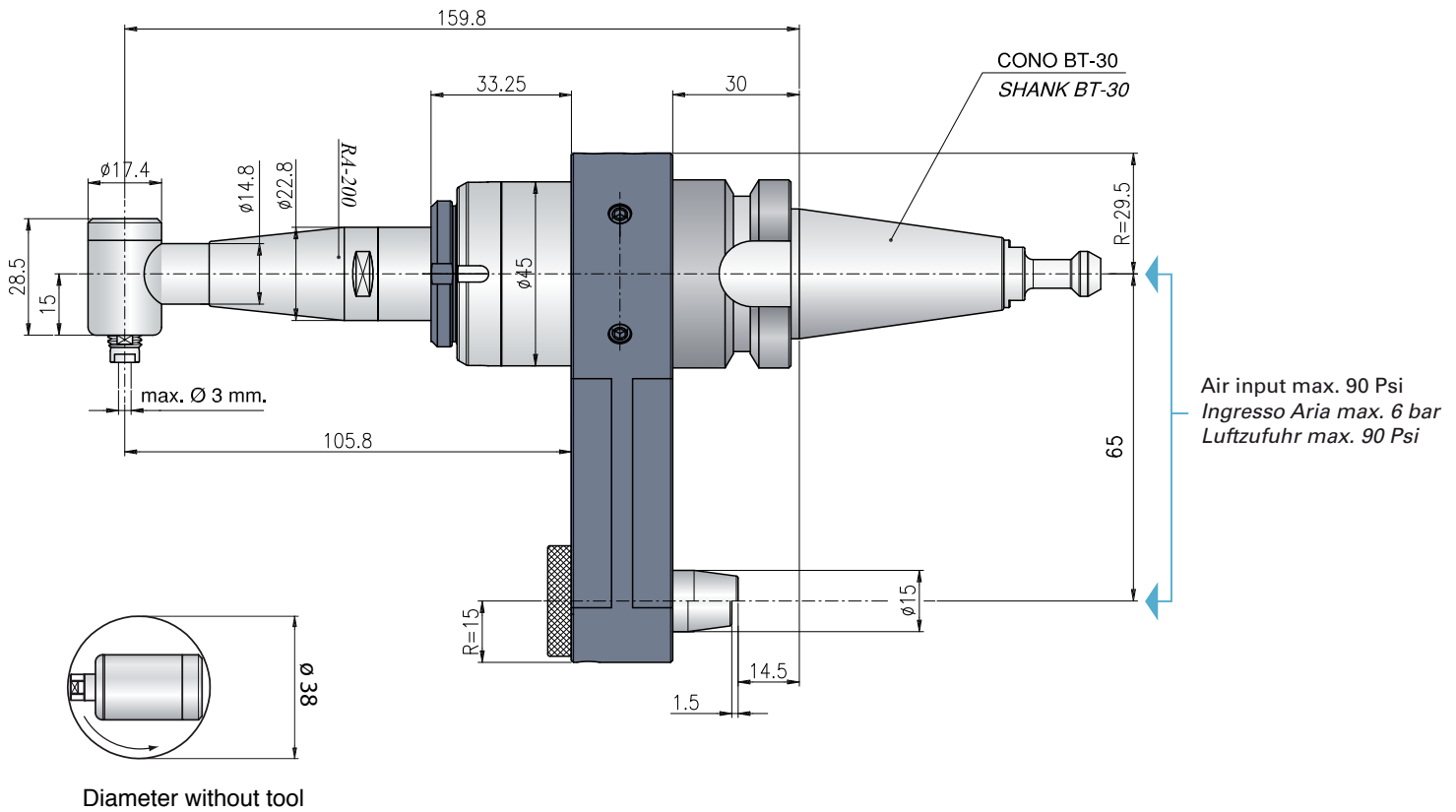

Accessories / Accessori / Zubehör	NR-2351	RA-200
Collet / Pinze / Spannzange	CHM Ø0,3mm, Ø3 every 0,1 and Ø2,35, Ø3,175	CHS Ø0,5, 3mm every 0,1
Retaining block / Tassello di ritegno / Stop block	Special stop block w/air stop valve	Special stop block w/air stop valve
Air line kit / Filtro regolatore aria / Luftsystem	AL-0304	AL-0304



In case of air through the spindle please use special pull stud!!!
 Nel caso di aria attraverso il mandrino utilizzare il tirante speciale !!!
 Im Fall von Luft durch die Spindel verwenden Sie bitte spezielle Zugbolzen !!!

Air line kit / Filtro regolatore aria / Luftsystem - for NR-601 / RA-200



SLIMLINE

Driven through machine motor / azionamento tramite mandrino macchina / durch die Spindel angetrieben

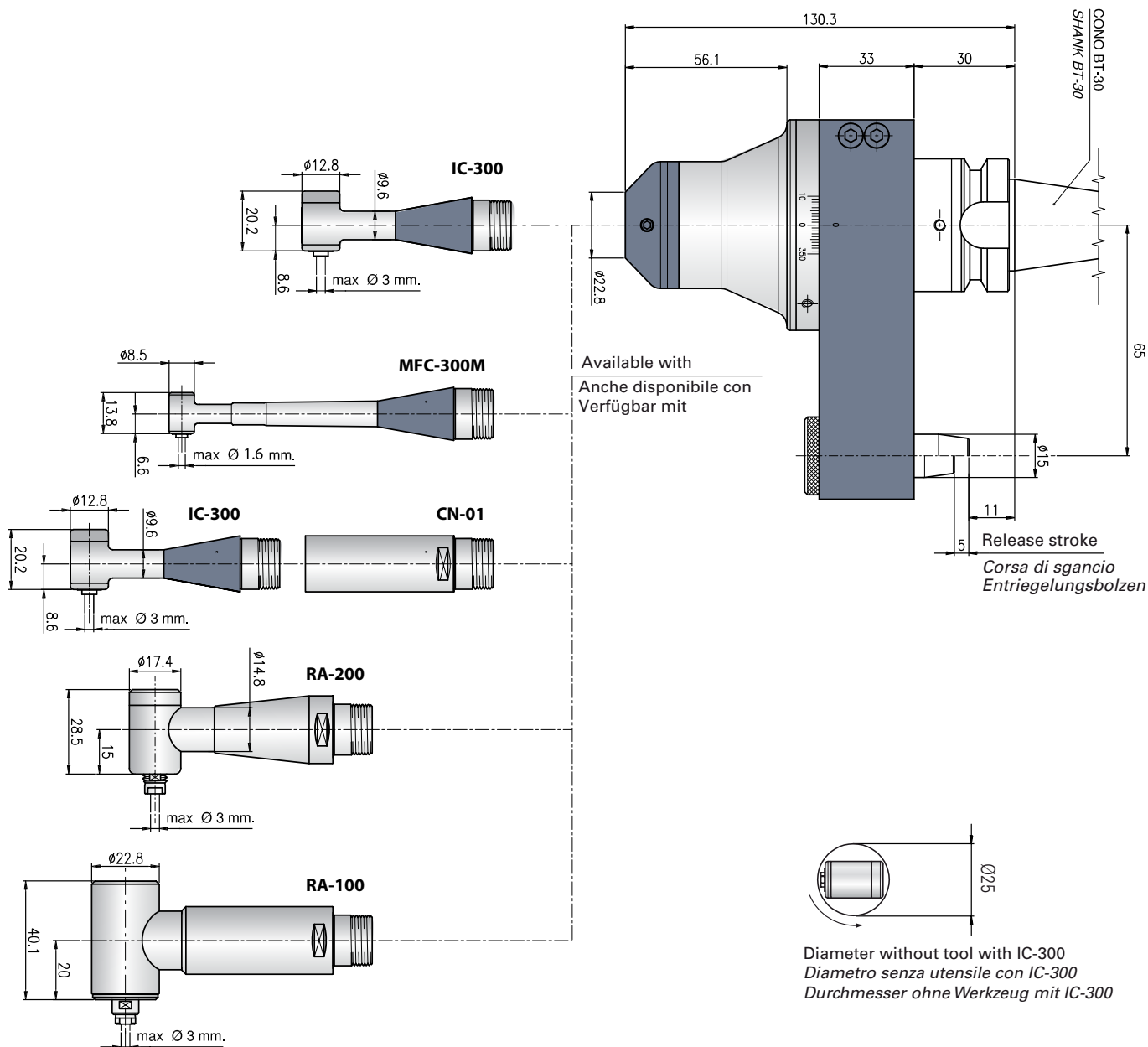

Technical Data / Dati Tecnici / Technische Daten

		IC-300*
RPM max. / Max. Velocità / Drehzahl max.	min ⁻¹	20.000
Rt. reduction / Rt. in riduzione / Rt. Reduktion		3/4
Collet / Pinze / Spannzange	mm	CHM $\phi 3$
Type Spindle / Tipo di manipo / Spindeltyp	W	IC-300
Rotation / Rotazione / Rotation		right/destra/recht, left/sinistra/links
Weight / Peso / Gewicht	Kg	3

STANDARD EQUIPMENT INCLUDES: NAKANISHI Kit / Angle head / Collet / Wrenches / Instruction book

* For special applications only / solo per applicazioni speciali / nur für Sonderanwendungen

MINILINE 1,5

Driven through machine motor / azionamento tramite mandrino macchina / durch die Spindel angetrieben

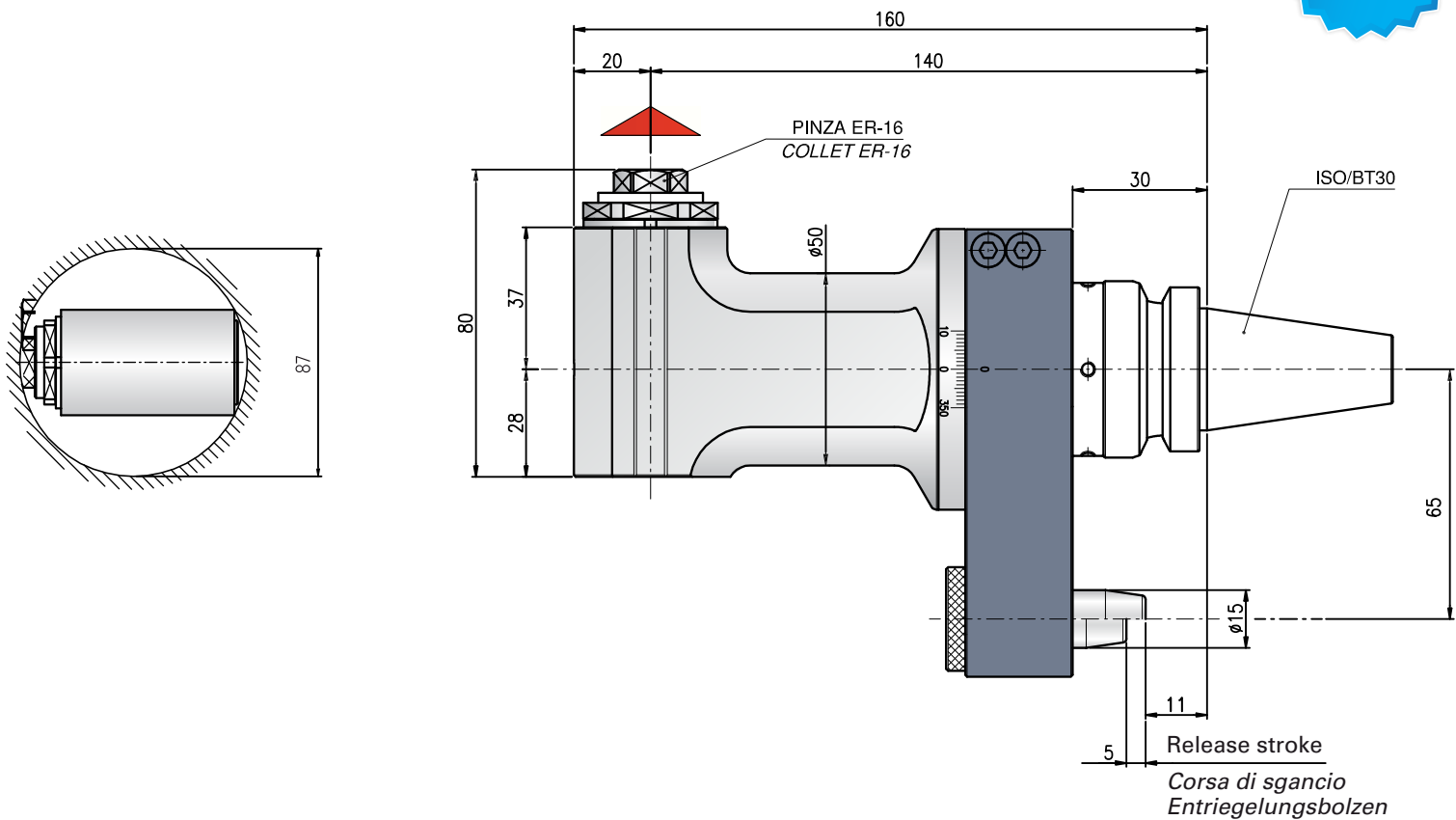

**Also available with coolant through the spindle (max 40 bar) and double output version.
Disponibile anche nelle versioni con refrigerante interno dal cono (max 40 bar) e con doppia uscita.**

 Direction of rotation opposite to machine spindle / senso di rotazione contrario al mandrino / Drehrichtung entgegen Antriebsspindel

Technical Data / Dati Tecnici / Technische Daten	MINILINE 1,5/30	
Rt / Rt / Rt		1:1
RPM max. / Max. velocità / Drehzahl max.	min ⁻¹	6.000
Max. axial load / Max. carico assiale / Max. Axialbelastung	N	250
Torque / Momento torcente / Drehmoment	Nm	7
Weight / Peso / Gewicht	kg	3
Collet / Pinza / Spannzange		ER-16 ø 1/10 mm

OPTIONAL

High speed / alta velocità / Höhere Drehzahl max 10.000 RPM

Coolant through the spindle / Refrigerazione attraverso il mandrino / Kühlmittelzufuhr durch die Spindel max 40 Bar

STANDARD EQUIPMENT INCLUDES: Angle head / Collet / Wrenches / Instruction book

OPTIONAL

Special stop block for / *Stop block speciale* / *Sonderblock für*
DMG Mori Seiki MILLTAP 700

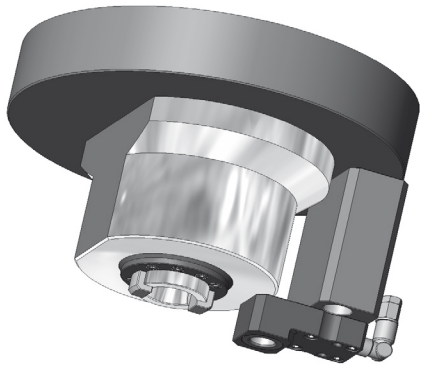

For the correct use of the air driven tools
Per il corretto utilizzo delle unità ad aria
Für eine richtige Verwendung von Luftköpfe

Air line kit Set-up

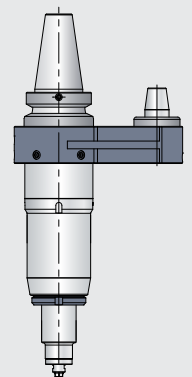
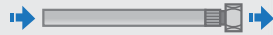
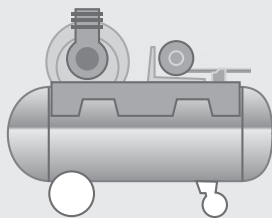

Compressor / Compresore / Kompressor

Air line kit AL-0304

Spindle / Mandrino / Spindeltyp



**Solutions up to 58.000 rpm for micromachining.
BT 30 spindle - automatic tool changer**



**TURBODRILL
MINILINE**

S2D / R2B

brother



TURBODRILL NR-2351

Driven through air motor / azionamento con motore ad aria / mit Luftmotor angetrieben

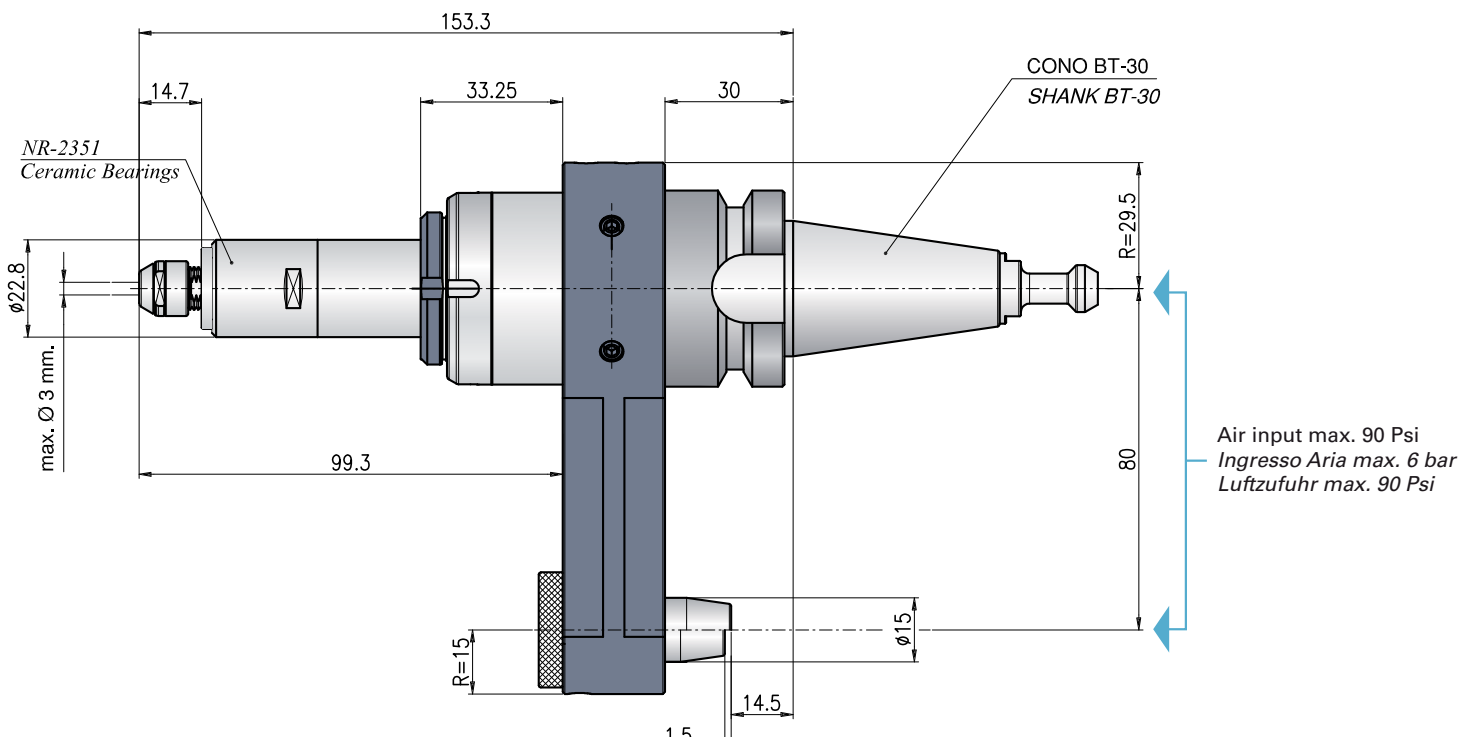

Technical Data / Dati Tecnici / Technische Daten		NR-2351	RA-200
RPM max. / Max. Velocità / Drehzahl max.	min ⁻¹	58.000	30.000
Type motor / Tipo di motore / motortyp		AM-600	AM-310
Collet / Pinze / Spannzange	mm	CHK $\phi 3$	CHS $\phi 3$
Power / Potenza / Energie	W	76	108
Rotation / Rotazione / Rotation		AM-600 RA Right, AM-600 LA Left	AM-310 RA Right, AM-310 LA Left
Air pressure / Pressione Aria / Luftdruck	Bar	max. 6 (max. 90 Psi)	max. 6 (max. 90 Psi)
Air consumption / consumo d'aria / Luftverbrauch	NI/min	160	226
Type Spindle / Tipo di manopolo / Spindeltyp		NR-2351	RA-200
Output RPM / N° Giri in uscita / Drehzahlausgang	min ⁻¹	58.000	20.000
Rt. reduction / Rt. in riduzione / Rt. Reduktion		--	1/1,5
Weight / Peso / Gewicht	Kg	2	2

STANDARD EQUIPMENT INCLUDES: NAKANISHI Kit / Angle head / Collet / Wrenches / Instruction book

**For the correct functioning of the tool the machine spindle must not rotate**

Per il corretto funzionamento il mandrino della macchina non deve ruotare / Für die korrekte Verwendung von Werkzeug soll die Maschinenspindel nicht drehen

SLIMLINE

Driven through machine spindle / azionamento tramite mandrino macchina / durch die Spindel angetrieben

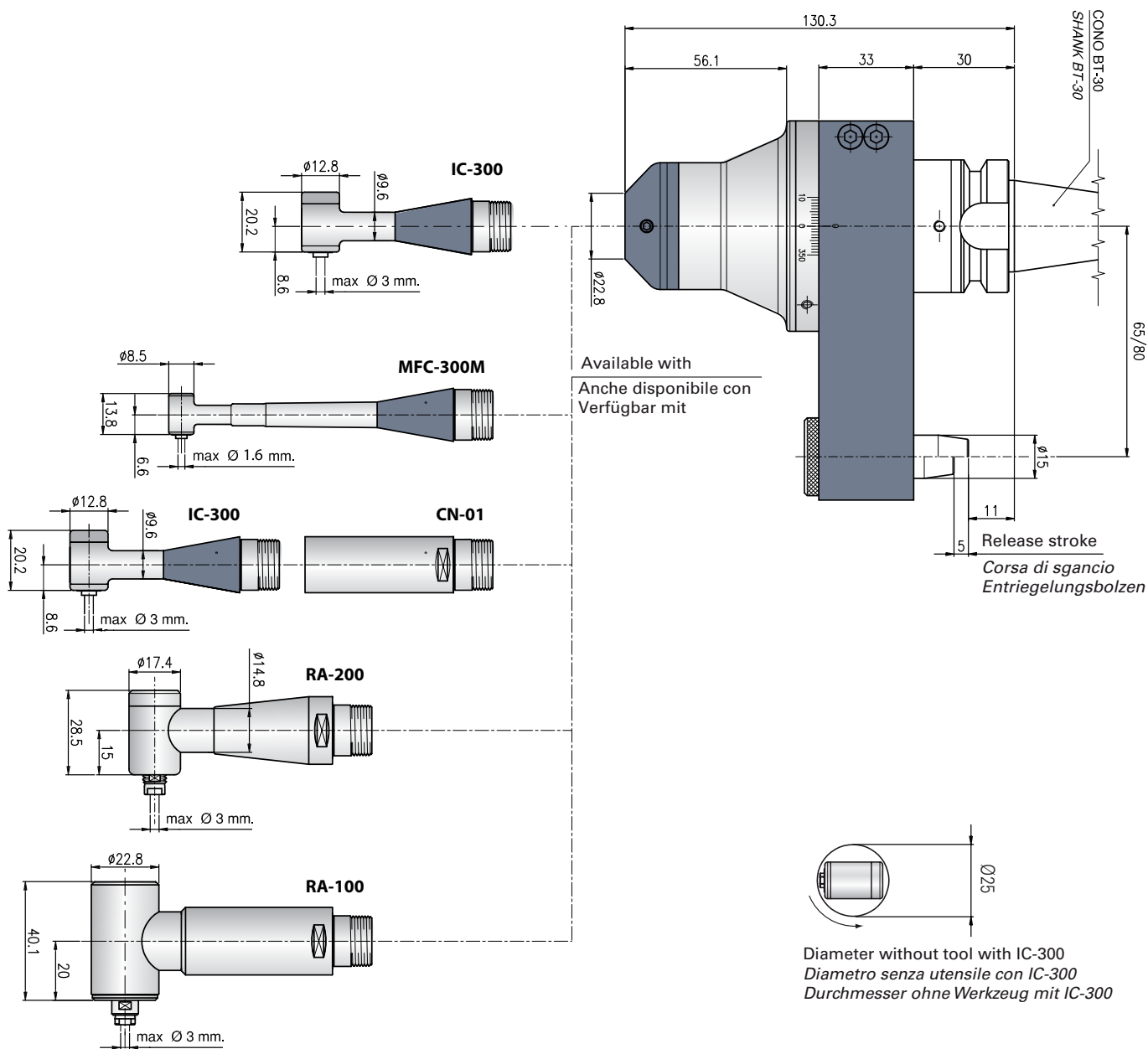

Technical Data / Dati Tecnici / Technische Daten

		IC-300*
RPM max. / Max. Velocità / Drehzahl max.	min ⁻¹	20.000
Rt. reduction / Rt. in riduzione / Rt. Reduktion		3/4
Collet / Pinze / Spannzange	mm	CHM Ø3
Type Spindle / Tipo di manipoło / Spindeltyp	W	IC-300
Rotation / Rotazione / Rotation		right/destra/recht, left/sinistra/links
Weight / Peso / Gewicht	Kg	3

STANDARD EQUIPMENT INCLUDES: NAKANISHI Kit / Angle head / Collet / Wrenches / Instruction book

* For special applications only / solo per applicazioni speciali / nur für Sonderanwendungen

MINILINE 1,5

Driven through machine spindle / azionamento tramite mandrino macchina / durch die Spindel angetrieben

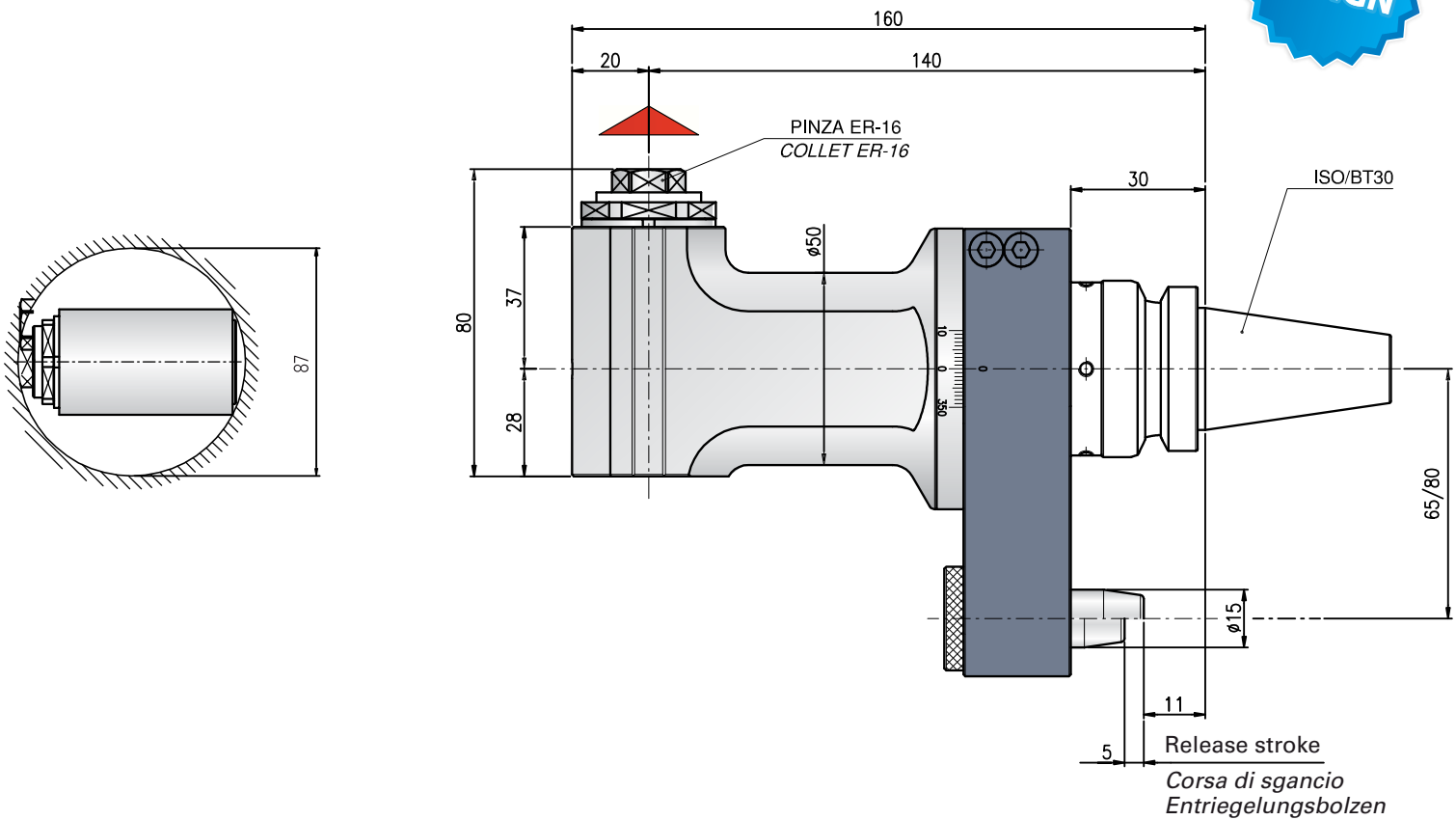

▲ Direction of rotation opposite to machine spindle / senso di rotazione contrario al mandrino / Drehrichtung entgegen Antriebsspindel

Technical Data / Dati Tecnici / Technische Daten**MINILINE 1,5/30**

Rt / Rt / Rt		1:1
RPM max. / Max. velocità / Drehzahl max.	min ⁻¹	6.000
Max. axial load / Max. carico assiale / Max. Axialbelastung	N	250
Torque / Momento torcente / Drehmoment	Nm	7
Weight / Peso / Gewicht	kg	3
Collet / Pinza / Spannzange		ER-16 ø 1/10 mm

OPTIONAL

High speed / alta velocità / Höhere Drehzahl max 10.000 RPM

Coolant through the spindle / Refrigerazione attraverso il mandrino / Kühlmittelzufuhr durch die Spindel max 40 Bar

STANDARD EQUIPMENT INCLUDES: Angle head / Collet / Wrenches / Instruction book

**Special stop block for / *Stop block speciale* / *Sonderblock für*
Brother S2D / R2B**



For the correct use of the air driven tools
Per il corretto utilizzo delle unità ad aria
Für eine richtige Verwendung von Luftköpfe

Air line kit Set-up

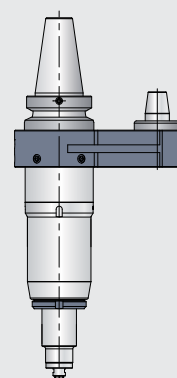
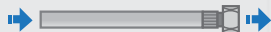
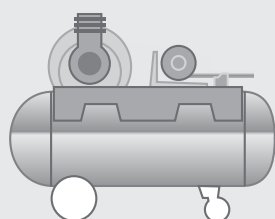

Compressor / Compensore / Kompressor

Air line kit AL-0304

Spindle / Mandrino / Spindeltyp